

*American Standard*

**SELECTRONIC®**  
**PROXIMITY URINAL CONCEALED**  
**FLUSH VALVE**  
**1.0, 0.5 & 0.125 GPF**

MODEL NUMBERS 1.0, 0.5, & 0.125 GPF		
6061.X10	6061.X05	6061.X01
6062.X10	6062.X05	6062.X01
6063.410	6063.405	6063.X01
6063.511	6063.515	

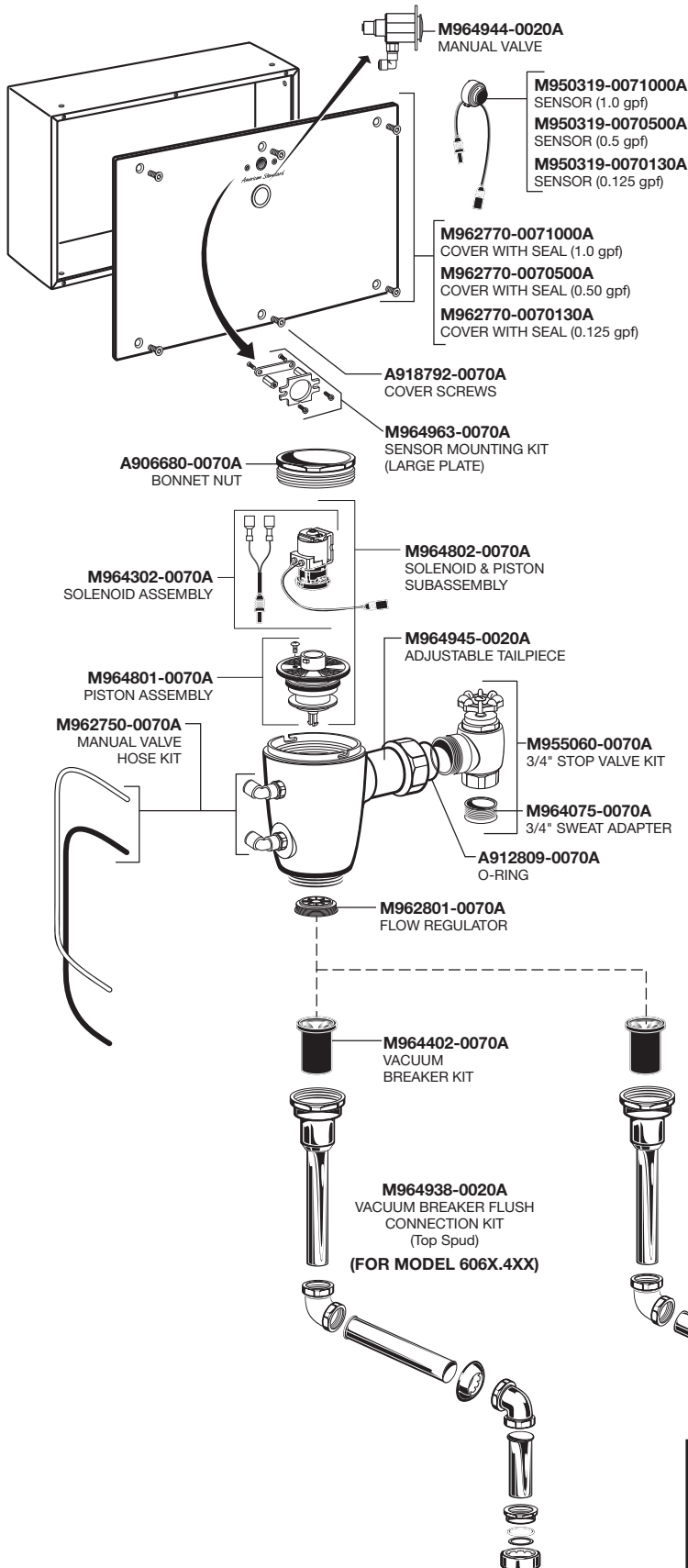

**DC STANDARD BATTERY**  
**6063. Series**

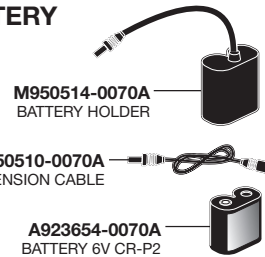

**AC Plug-in**  
**6062. Series**

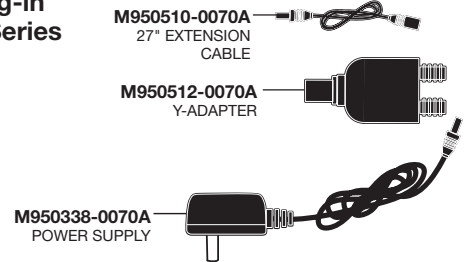

**AC Multi**  
**6061. Series**

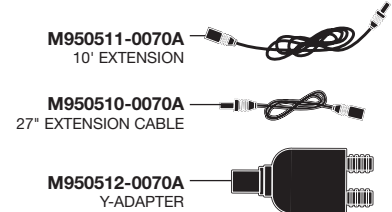

**HOT LINE FOR HELP**  
 For toll-free information and answers to your questions, call:  
 (844) CRT-TEAM / (844) 278-8326  
 Mon. - Fri. 8:00 a.m. to 8:00 p.m. EST Sat. 10:00 a.m. to 4:00 p.m. EST  
 IN MEXICO 01-800-839-1200  
 IN CANADA 1-800-387-0369 (TORONTO 1-905-306-1093)  
 Weekdays 8:00 a.m. to 7:00 p.m. EST

Product names listed herein are trademarks of AS America, Inc. ©2015

To learn more about American Standard Selectronic® Products visit our website at:  
[www.americanstandard-us.com](http://www.americanstandard-us.com) or e-mail us at: [CRTTEAM@americanstandard.com](mailto:CRTTEAM@americanstandard.com)