

*American Standard*

**SELECTRONIC®**  
**PROXIMITY TOILET**  
**CONCEALED FLUSH VALVE**  
**1.28 & 1.6 GPF**

MODEL NUMBERS	
6065.22X	6065.26X
6067.22X	6067.26X
6068.22X	6068.26X

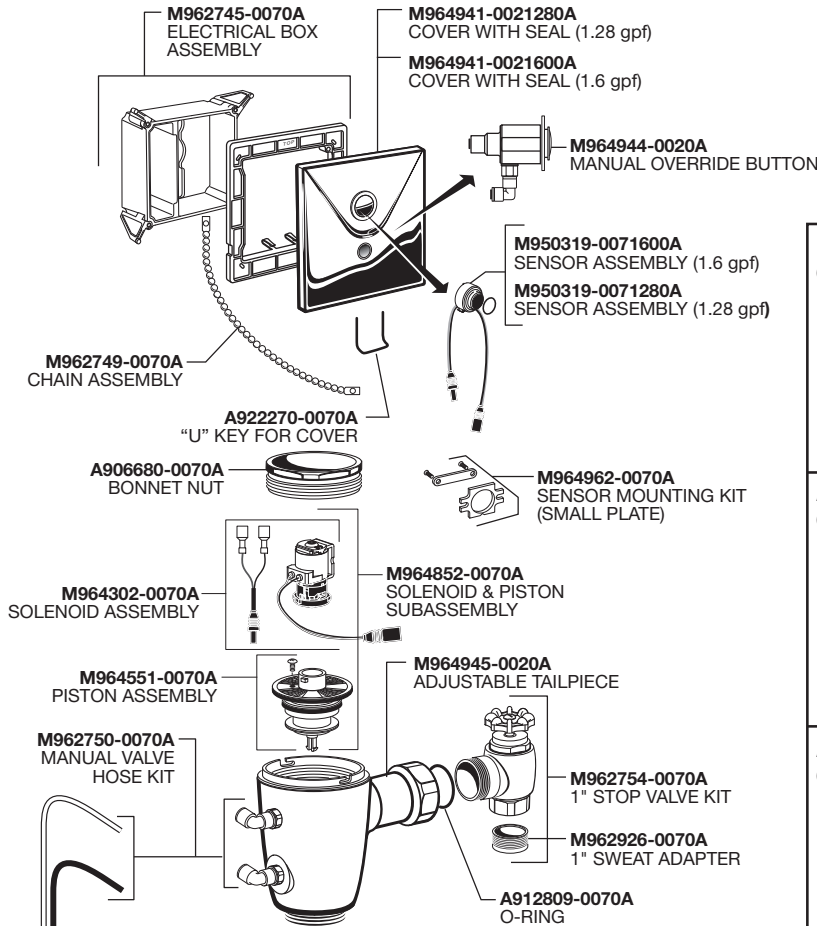

**DC STANDARD BATTERY**  
**6065. Series**

**M950514-0070A** BATTERY HOLDER  
**M950510-0070A** 27" EXTENSION CABLE  
**A923654-0070A** BATTERY 6V CR-P2

**AC Plug-in**  
**6067. Series**

**M950512-0070A** Y-ADAPTER  
**M950510-0070A** 27" EXTENSION CABLE  
**M950338-0070A** POWER SUPPLY

**AC Multi**  
**6068. Series**

**M950511-0070A** 10' EXTENSION  
**M950510-0070A** 27" EXTENSION CABLE  
**M950512-0070A** Y-ADAPTER

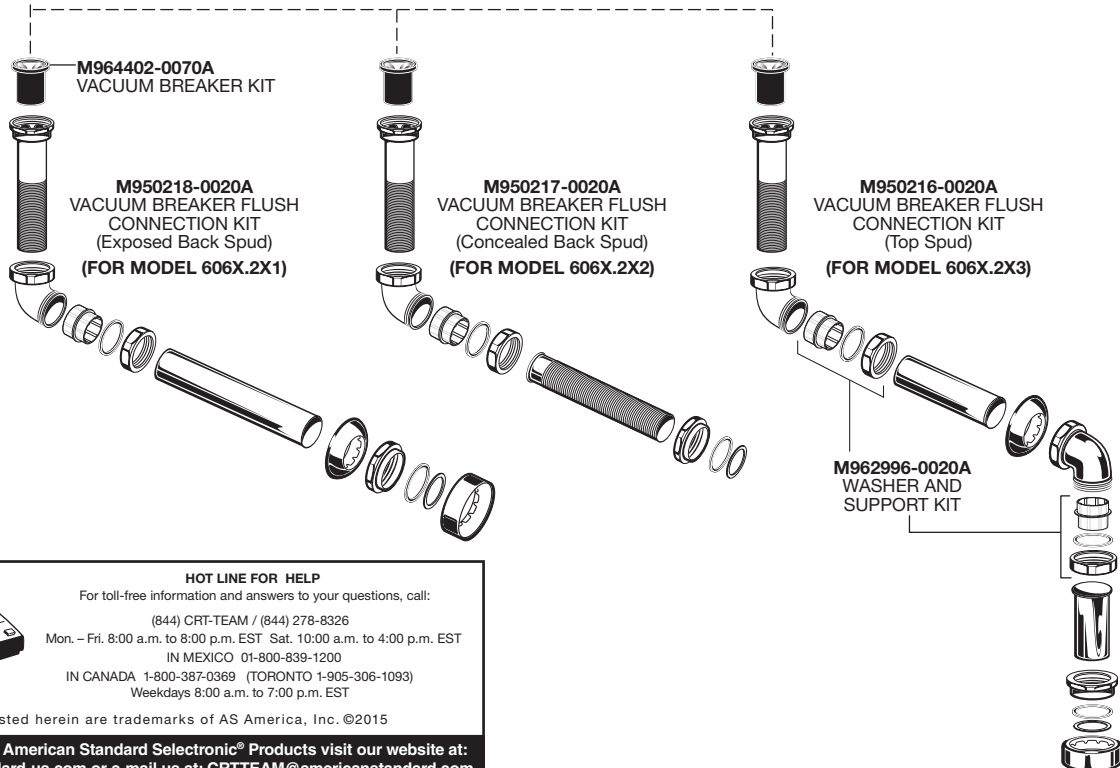

**HOT LINE FOR HELP**  
 For toll-free information and answers to your questions, call:  
 (844) CRT-TEAM / (844) 278-8326  
 Mon. - Fri. 8:00 a.m. to 8:00 p.m. EST Sat. 10:00 a.m. to 4:00 p.m. EST  
 IN MEXICO 01-800-839-1200  
 IN CANADA 1-800-387-0369 (TORONTO 1-905-306-1093)  
 Weekdays 8:00 a.m. to 7:00 p.m. EST

Product names listed herein are trademarks of AS America, Inc. ©2015

To learn more about American Standard Selectronic® Products visit our website at:  
[www.americanstandard-us.com](http://www.americanstandard-us.com) or e-mail us at: [CRTTEAM@americanstandard.com](mailto:CRTTEAM@americanstandard.com)